



15 Meadowfield Gardens

Walkerville, Newcastle Upon Tyne, NE6 4TA

**** THIS PROPERTY IS NOW "SALE AGREED" AND THERE ARE TO BE NO FURTHER VIEWINGS - WE WOULD LOVE TO HEAR FROM YOU IF YOU HAVE A PROPERTY TO SELL AND WANT ONE OF OUR "GONE" BOARDS TOO! PLEASE GET IN TOUCH ****

**** TWO BEDROOM END TERRACE BUNGALOW ** MODERN KITCHEN WITH INTEGRATED APPLIANCES ** LOUNGE & DINING ROOM ** GARAGE & OFF STREET PARKING ** LOW MAINTENANCE TO REAR ****

CLOSE TO SHOPS & BUS SERVICES ** BEAUTIFULLY PRESENTED AND READY TO MOVE INTO **

FREEHOLD ** COUNCIL TAX BAND B ** ENERGY RATING D **

Offers Around £209,950

15 Meadowfield Gardens

Walkerville, Newcastle Upon Tyne, NE6 4TA



- Two Bedroom End Terrace Bungalow
- Modern Refitted Shower Room
- Freehold
- Well Presented & Ready To Move Into
- Garage & Off Street Parking
- Council Tax Band B
- Modern Kitchen With Integrated Appliances
- Close To Local Amenities
- Energy Rating D

Entrance Lobby

Hallway

Lounge

12'9" x 11'9" + bay (3.91 x 3.60 + bay)

Dining Room

12'7" x 11'11" (3.85 x 3.64)

Kitchen

13'3" x 6'7" +8'6" x 6'2" (4.06 x 2.02 +2.60 x 1.88)

Bedroom 1

12'10" x 11'10" (3.93 x 3.62)

Bedroom 2

11'11" x 6'11" (3.64 x 2.13)

Shower Room

8'1" x 7'11" (2.47 x 2.43)

Garage

14'0" x 13'0" (4.29 x 3.98)

External

Broadband



Directions







Floor Plan

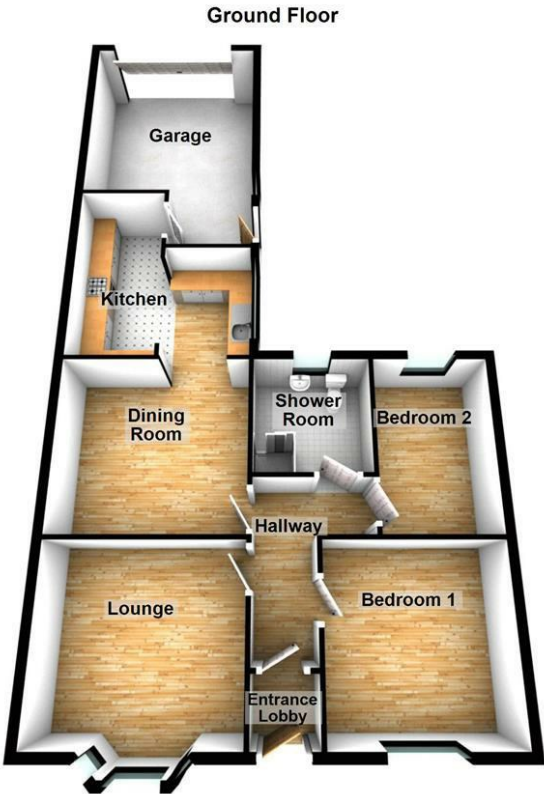

These particulars, whilst believed to be accurate are set out as a general outline only for guidance and do not constitute any part of an offer or contract. Intending purchasers should not rely on them as statements of representation of fact, but must satisfy themselves by inspection or otherwise as to their accuracy. No person in this firms employment has the authority to make or give any representation or warranty in respect of the property.

Energy Efficiency Rating		
	Current	Potential
Very energy efficient - lower running costs		
(92 plus) A		
(81-91) B		81
(69-80) C		
(55-68) D	64	
(39-54) E		
(21-38) F		
(1-20) G		
Not energy efficient - higher running costs		
England & Wales		EU Directive 2002/91/EC